



LARGE ISLAND WITH SEATING

If you are going for the grand kitchen, this is the island for you! As we designed it below, this island is 72" by 54", so you will need a lot of space but it features storage for everything you will need in the kitchen. With storage on all sides, seating in the back, and the option for a sink in the middle, this will give you space or work, storage, and seating. The sizes can be adjusted to fit your kitchen, but we tried to replicate the picture as much as possible.

Supplies You Will Need from the RTA Cabinet Store

- ✓ Three 24" base cabinets
- ✓ Two 18" drawer base cabinets
- ✓ Two 12" wide x 30" high wall cabinets
- ✓ Two island panels
- ✓ Four 30" decorative wall end panels
- ✓ Two decorative base end panels
- ✓ Four 8' pieces of toe kick
- ✓ Pint of Stain
- ✓ 2x4's from your local supply store

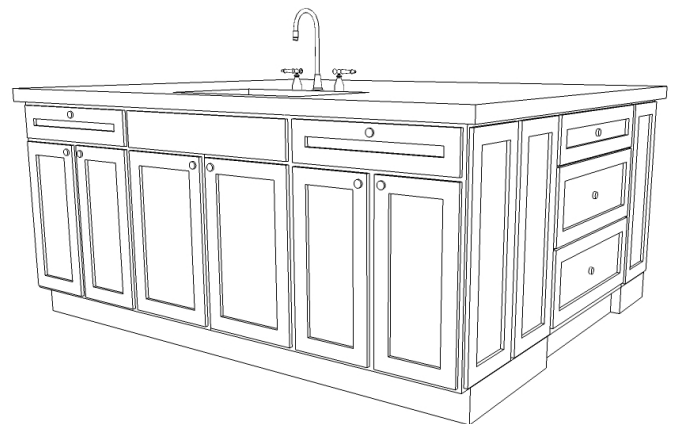
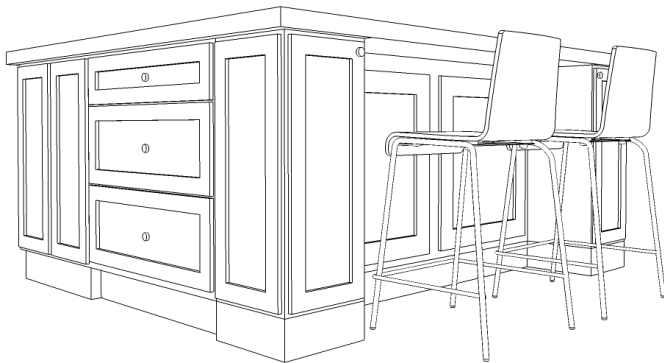
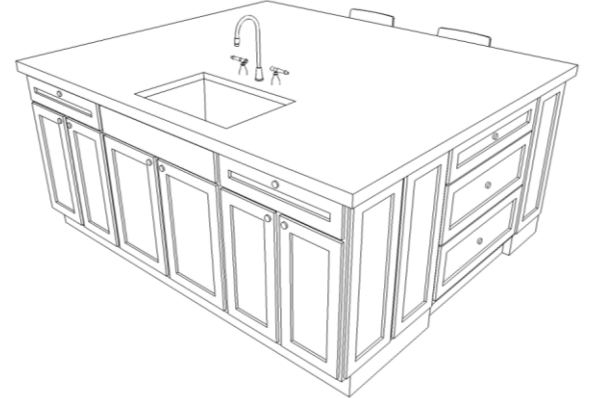

RTA
CABINET STORE

www.rtacabinetstore.com
P. 610-337-5934 F. 484-231-8726

Instructions to Build a Large Island with Seating

- Step 1: Starting with the three 24” base cabinets, install them in place. As with any island, it is a good idea to secure nailing boards to the floor to secure the base cabinets to. Secure the cabinets to each other through the face frames. (Note: if you are installing a sink in the center base cabinet, you won’t use the drawer. Take the drawer front and secure it to the front of the cabinet so that the sink will fit.)
- Step 2: Take the two drawer base cabinets, which will be used on the two ends. Line the face frame of the drawer base cabinets with the sides of the two exterior sides of the 24” base cabinets. (Note: the toe kick area will be covered up, so it won’t matter that it is set back.)
- Step 3: Using pieces of 2x4, create two platforms for the two 12” wall cabinets to sit on. The frames should be 12” wide x 12” deep x the height of the toe kick.
- Step 4: Secure the bases in place, lining up the edge of the frame with the edge of the face frames for the two drawer base cabinets (the 2x4’s will be covered up with toe kick).
- Step 5: Once secured in place, attach the wall cabinets, securing them to both the framing and the base cabinets behind them.
- Step 6: Take the island panels, and cut them to length to fit the exposed back of the 24” base cabinets that is left between the wall cabinets (this will be visible from the seating side).
- Step 7: Using the four pieces of toe kick, run it all the way around the island to create a uniform look on the bottom. To replicate the picture, the toe kick should stick out slightly from the face of the cabinet. To achieve this where the three 24” base cabinets are, you will need to create some nailing supports or nailing blocks.
- Step 8: Once the toe kick is in place, secure the decorative end panels. The wall end panels should go on both sides of the wall cabinets. The decorative base panels should go on the exposed sides of the 24” base cabinets, and on the back side of the 24” base cabinets where the island panels were installed.
- Step 9: Once everything is installed, use the stain for any touchups.

My Design Notes